

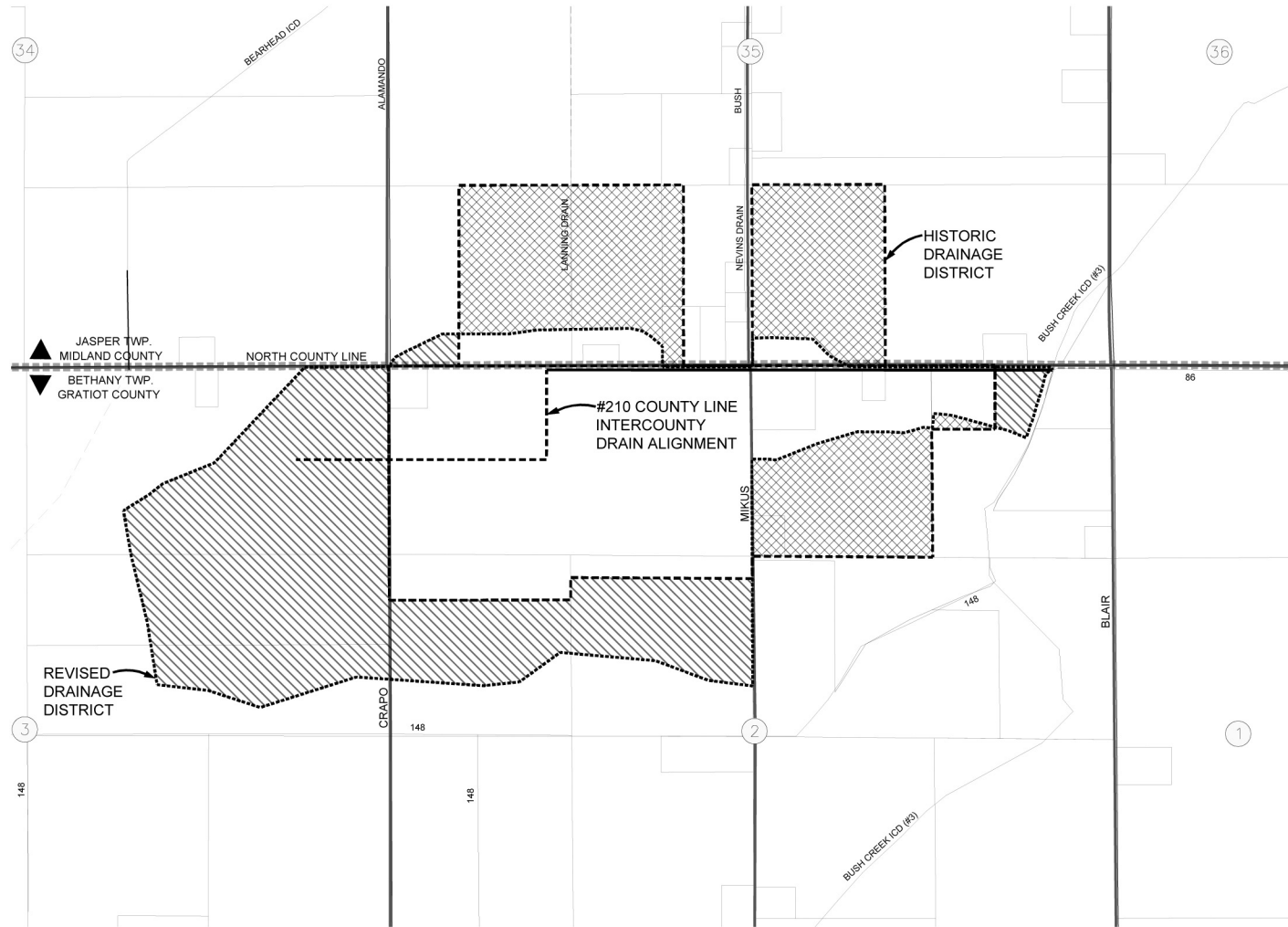

# #210 County Line Intercounty Drain

Sections 2-3  
T12N, R02W  
Bethany Township,  
Gratiot County, Michigan

Section 35  
T13N, R02W  
Jasper Township,  
Midland County, Michigan



DRAINAGE DISTRICT INFORMATION:	
HISTORIC DISTRICT:	226.16 ACRES
REVISED DISTRICT:	256.88 ACRES
LANDS ADDED:	125.79 ACRES
LANDS REMOVED:	95.07 ACRES
DRAIN LENGTH:	1.17 MILES

## LEGEND

	LANDS REMOVED
	LANDS ADDED
	DRAIN ALIGNMENT (OPEN CHANNEL)
	DRAIN ALIGNMENT (ENCLOSED)
	HISTORIC DRAINAGE DISTRICT BOUNDARY
	REVISED DRAINAGE DISTRICT BOUNDARY
	CITY/VILLAGE LIMITS
	PARCEL LINES
	ROADS
	SECTION LINES
	TOWNSHIP LINE
	COUNTY LINE
	SECTION NUMBERS



NOT TO SCALE

## MAILING MAP

	2121 3 Mile Rd. NW Walker, MI 49544 Ph: 516.507.7888 www.LREMI.com	PROJECT#: 25-033 DRAWN BY: LGG DATE: JULY, 2025 SHEET: 1/10